

1570 CHATEAUNEUF SOLAR

“Medium” version in the round flush recessed raking light range. The flange hides any imperfections in the recess.

APPLICATIONS :

- Decorative marker-lighting
- Installed at regular intervals to mark a path, cycle path, stairs
- Public space enhancement

CARACTÉRISTICS

- Anodised aluminium body
- Vandal-proof organic glass window
- For embedding and gluing to walls, bollards, masts or other supports
- Withstands occasional traffic from all kinds of vehicles
- RGBW
- LiFePO4 1000mAh Battery
- Sunpower Back Contact Solar Panel
- Operating temperature: -10°C / 60°C
- Battery life: 130 hours

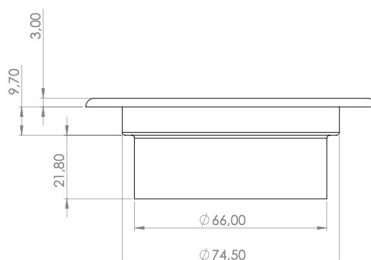
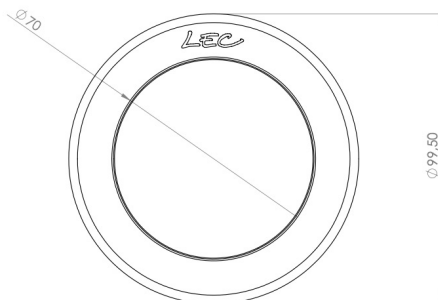

Number of LEDs	2
Type of LEDs	LED CMS at 120° + CMS trichromatic
Luminous effect	Balise RGB, Blanc 4000 K

APPLICATION

- Marker-lighting

PLACEMENT

- Ground flush recessed fittings
- Ground recessed fittings

CARACTÉRISTICS

Poids : 520g

Luminous effect

- RGBW option
- Transparent flat window
- Colour control system

Material

- **AL** Anodised glazed aluminium
- **PC 2** Vandal-proof, scratch-proof, UV-proof, polycarbonate window, M2

Mechanical Strength – Waterproofing

IK10 60J Resists impacts up to IK10 60J

IP68 Watertight for extended immersion

Product set-up

- Bluetooth Connexion via configuration

Download our product brochure:



Technical data is subject to changes. Luminaires guaranteed 5 years.
Luminaires designed and manufactured in France. 