

## 1830KH LUCERNE

«Medium» version in the round flush recessed raking light range. Choice of lighting effects for customised LED marker-lighting.

### APPLICATIONS:

- Decorative or safety marker-lighting
- Installed at regular intervals to mark a path, cycle path, stairs
- Public space enhancement

### CARACTERISTICS

Projector equipped with a stainless steel flange of Ø 120 mm with a 4 mm thick protusion. The flange hides recess plate imperfections. Homogeneous window. This projector 1830K does not withstand occasional vehicles driving.

- Anodised aluminium body
- Vandalproof organic glass window
- 316L Stainless steel screws
- Flush-recessed (except 1830K and 1830D)
- RGB options available

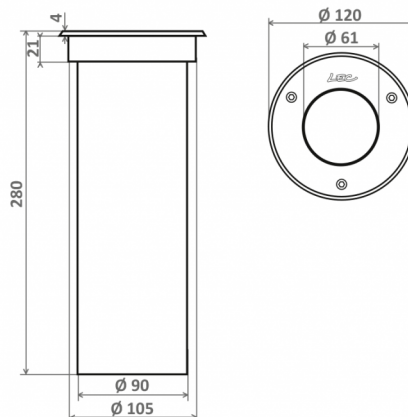

|                |   |
|----------------|---|
| Number of LEDs | 36, 12, 4   |
| Type of LEDs   | 120° SMD LEDs (S), SMD trichro (A), Power LEDs. Contact us for hot countries.   |
| Color(s)       | Warm white 2700K (F), Warm white 3000K (E), Neutral white 4000K (N), Cool white 6000K (W), Red (R), Amber (O), Green (V), Blue (L), RVB (T), Royal blue (K) |

Select your specific requirements with our product configurator, by filtering technical criteria at the following link:  
<http://www.lec-lyon.com/1830khz-lucerne-r913>

### APPLICATION

- Marker-lighting

### CONFIGURATEUR.EMPLACEMENT

- Ground recessed fittings

### CARACTERISTICS

Weight : 450 g

### Options of luminous effects

- RGB options
- Adjustable on 1 axis
- Flat homogeneous window (optional)
- Colour control system (optional)

### Power supply - Control

- Cable length: 1 m
- Integrated : 24V-PWM
- Remote : 24V-0/10V, 24V-DMX, 24V-DALI
- Integrated : 230V-Non dimmable

### Material

- Anodised glazed aluminium
- 316L Stainless steel
- Vandalism-proof, scratch-proof, UV-proof, polycarbonate window, M2

### Mechanical strength - Waterproofness

- Resists impacts up to IK10 60J
- Tight for extended immersion