

## 1830KM LUCERNE

«Medium» version in the round flush recessed raking light range. Choice of lighting effects for customised LED marker-lighting.

### APPLICATIONS:

- Decorative or safety marker-lighting
- Installed at regular intervals to mark a path, cycle path, stairs
- Public space enhancement

### CARACTERISTICS

The flange hides recess plate imperfections. Angled LED with internal mirror for 360° flush raking light.

- Anodised aluminium body
- Vandalproof organic glass window
- 316L Stainless steel screws
- Flush-recessed (except 1830K and 1830D)

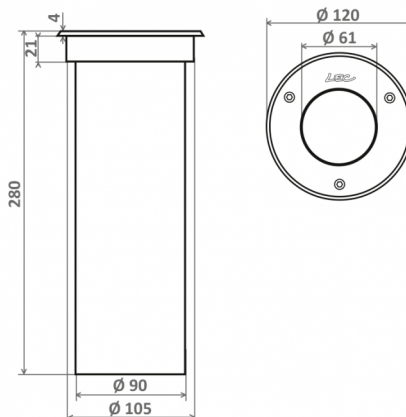

Number of LEDs	16
Type of LEDs	Wide angle 5 mm LEDs (H)
Color(s)	Warm white 3000K (E), Neutral white 4000K (N), Cool white 6000K (W), Red (R), Amber (O), Green (V), Blue (L)

Select your specific requirements with our product configurator, by filtering technical criteria at the following link:

<http://www.lec-lyon.com/1830kmz-lucerne-r970>

### APPLICATION

- Marker-lighting

### CONFIGURATEUR.EMPLACEMENT

- Ground recessed fittings

### CARACTERISTICS

Weight : 450 g

### Options of luminous effects

- Adjustable on 1 axis
- Inclined beam
- Transparent flat window

### Power supply - Control

- Cable length: 1 m

**Integrated :** 24V-PWM  
 **Remote :** 24V-0/10V, 24V-DMX, 24V-DALI

### Material

- Anodised glazed aluminium
- 316L Stainless steel
- Vandalism-proof, scratch-proof, UV-proof, polycarbonate window, M2

### Mechanical strength - Waterproofness

- Resists impacts up to IK10
- 60J
- Tight for extended immersion