

4010 LUMINY

«Mini» version in the Luminy spotlight range.

Installs on roads/floors, wall or poles with bespoke accessories.

APPLICATIONS:

- Highlight architectural features
- Highlight landscapes
- Path, alley, street furniture

CARACTERISTICS

- Anodised machined aluminium body
- Vandalproof organic glass window
- 316L Stainless steel bracket and screws
- Thermolacquered bracket on request

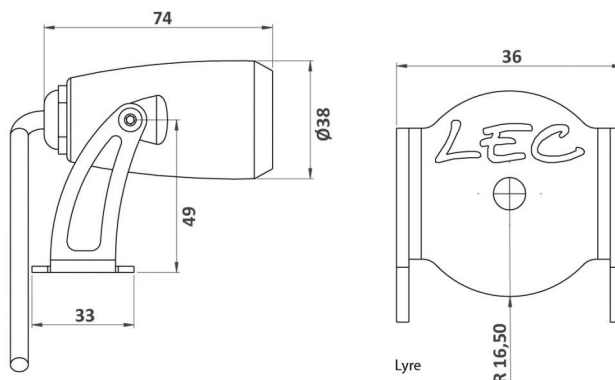

Number of LEDs	1
Type of LEDs	Power LEDs. Contact us for hot countries.
Color(s)	Warm white 2700K (F), Warm white 3000K (E), Neutral white 4000K (N), Cool white 6000K (W), Red (R), Amber (O), Green (V), Blue (L), Royal blue (K)

Select your specific requirements with our product configurator, by filtering technical criteria at the following link:

<http://www.lec-lyon.com/4010-luminy-r136>

APPLICATION



Outdoor lighting

Standard flux : 223 lm

This value is gained from the optimum output of the LED number, inclusive of optic, for a cool white LED (6000K)

CONFIGURATEUR.EMPLACEMENT



Wall lights



Masts

CARACTERISTICS

Weight : 220 g

Options of luminous effects



Adjustable on 2 axis



Rotating beam



Beam with various openings



Transparent flat window

Power supply - Control



Cable length: 1 m



Integrated : 24V-PWM
Remote : 24V-0/10V, 24V-DMX, 24V-DALI

Material



Anodised glazed aluminium



Vandalism-proof, scratch-proof, UV-proof, polycarbonate window, M2

Mechanical strength - Waterproofness



IK10 Resists impacts up to IK10
20J 20J



IP67 Tight for temporary immersion

4010 LUMINY

This datasheet gives you all the available optics for this product, consistent with the number of LEDs.

URL of this product: <http://www.lec-lyon.com/4010-luminy-r136>

