

1830K LUCERNE

«Medium» version in the round flush recessed raking light range.

APPLICATIONS:

- Highlight architectural features, street furniture, landscapes...
- Surface mounted lighting for cycle path, pedestrian path, stairs
- Squares and public places

CARACTERISTICS

Projector equipped with a stainless steel flange of Ø 120 mm with a 3 mm thick protusion.

The flange hides recess plate imperfections.

This projector 1830K does not withstand occasional vehicles driving.

- Anodised aluminium body
- Vandalproof organic glass window
- 316L Stainless steel screws
- Flush-recessed (except 1830K and 1830D)

- RGBW options available

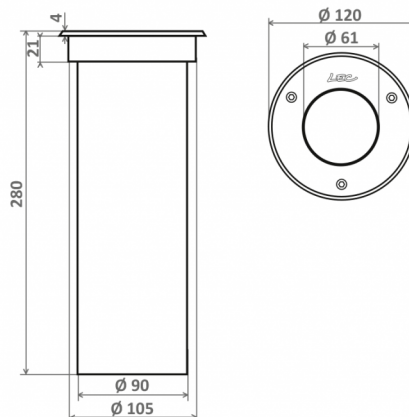

Number of LEDs	4
Type of LEDs	Power LEDs. Contact us for hot countries.
Color(s)	Warm white 2700K (F), Warm white 3000K (E), Neutral white 4000K (N), Cool white 6000K (W), Red (R), Amber (O), Green (V), Blue (L), Royal blue (K)

Select your specific requirements with our product configurator, by filtering technical criteria at the following link:

<http://www.lec-lyon.com/1830k-lucerne-r851>

APPLICATION



Outdoor lighting

Standard flux : **892 lm**

This value is gained from the optimum output of the LED number, inclusive of optic, for a cool white LED (6000K)

CONFIGURATEUR.EMPLACEMENT



Ground recessed fittings

CARACTERISTICS

Weight : **525 g**

Options of luminous effects



RGBW option



Adjustable on 1 axis



Transparent flat window



Colour control system (optional)

Power supply - Control



Cable length: **1 m**



Integrated : 24V-PWM
Remote : 24V-0/10V, 24V-DMX, 24V-DALI



Integrated : 230V-Non dimmable

Material



Anodised glazed aluminium



316L Stainless steel



Vandalism-proof, scratch-proof, UV-proof, polycarbonate window, M2

Mechanical strength - Waterproofness



IK10 Resists impacts up to IK10
20J



IP68 Tight for extended immersion

1830K LUCERNE

This datasheet gives you all the available optics for this product, consistent with the number of LEDs.

URL of this product: <http://www.lec-lyon.com/1830k-lucerne-r851>

